



## Power Bank with Car Charger PB26C

### FCC Information

This device complies with Part 15 of the FCC Rules. Operation is subject to the following two conditions: (1) this device may not cause harmful interference, and (2) this device must accept any interference received, including interference that may cause undesired operation.

Note: This equipment has been tested and found to comply with the limits for a Class B digital device, pursuant to Part 15 of FCC Rules. These limits are designed to provide reasonable protection against harmful interference in a residential installation. This equipment generates, uses, and can radiate radio frequency energy and, if not installed and used in accordance with the instructions, may cause harmful interference to radio communications.

However, there is no guarantee that interference will not occur in a particular installation. If this equipment does cause harmful interference to radio or television reception, which can be determined by turning the equipment off and on, the user is encouraged to try to correct the interference by one or more of the following measures:

- Reorient or relocate the receiving antenna.
- Increase the separation between the equipment and receiver.
- Connect the equipment into an outlet on a circuit different from that to which the receiver is connected.
- Consult the dealer or an experienced radio/TV technician for help.

Changes or modifications not expressly approved by VOXX Accessories Corporation could void the user's authority to operate the equipment.

### Industry Canada Regulatory Information

CAN ICES-3 (B)/NMB-3 (B)

Avis d'Industrie Canada

CAN ICES-3 (B)/NMB-3 (B)



### IMPORTANT SAFETY INSTRUCTIONS

#### PLEASE READ AND SAVE THIS FOR FUTURE REFERENCE

Some of the following information may not apply to your particular product; however, as with any electronic product, precautions should be observed during handling and use.

- Read these instructions.
- Keep these instructions.
- Heed all warnings.
- Follow all instructions.
- Do not use this apparatus near water.
- Clean only with dry cloth.
- Do not install near any heat sources such as radiators, heat registers, stoves, or other apparatus (including amplifiers) that produce heat.
- Refer all servicing to qualified service personnel. Servicing is required when the apparatus has been damaged in any way, such as power-supply cord or plug is damaged, liquid has been spilled or objects have fallen into the apparatus, the apparatus has been exposed to rain or moisture, does not operate normally, or has been dropped.

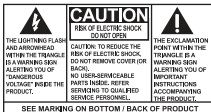

SEE MARKING ON BOTTOM / BACK OF PRODUCT

**WARNING: TO PREVENT FIRE OR ELECTRICAL SHOCK HAZARD, DO NOT EXPOSE THIS PRODUCT TO RAIN OR MOISTURE.**

### ADDITIONAL SAFETY INFORMATION

- Apparatus shall not be exposed to dripping or splashing and no objects filled with liquids, such as vases, shall be placed on the apparatus.
- Do not attempt to disassemble the cabinet. This product does not contain customer serviceable components.
- The marking information is located at the bottom of apparatus.

### Important battery information

Warning: Your product contains a battery and charging system which is designed to work in temperatures that do not exceed 50°C (122°F). Leaving this product in a closed automobile or the trunk of an automobile where temperatures may exceed 50°C may result in permanent battery damage, fire, or explosion. Please remove your product from the automobile when you exit, do not place your product in the trunk of your automobile, and do not leave your product in any location where temperatures may exceed 50°C.

### Ecology

Your product must be disposed of properly according to local laws and regulations. Because this product contains a battery, the product must be disposed of separately from the household waste.

**Note:** This power unit should be plugged in so that it stays vertical or lays flat.

### Introduction

The AR Here to Anywhere Power Bank Charge System uses a patent-pending design to make sure you have charging and backup power whenever you need it. The system charges your mobile device in car, while at the same time charging the backup mobile power bank battery. When you're ready to go, your power is too: simply take your device and throw the mobile battery into your bag for power to last throughout the day.

### Tour of the Power Bank

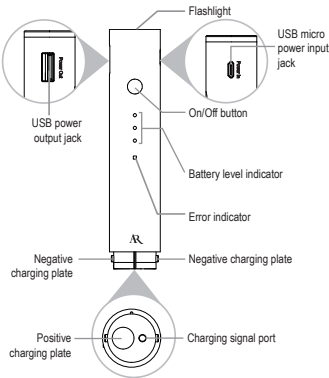

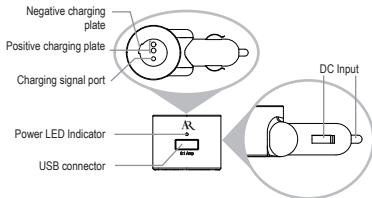

## Tour of the Car Charger



## Charging the Power Bank

Before you start using your power bank, you need to charge its built-in battery. There are two ways to charge your power bank battery. You can charge using the included car base charging dock, or you can charge directly with the provided micro USB cable using any USB power source (like the charger provided by your device, a computer or any USB charger).

### Charging the Power Bank Using the Car Base

Connect the Power Bank into the Car Base charger. Follow the Lock  and  Unlock icons on the base. Then turn clockwise to lock the Power Bank in place and the battery will begin charging. You should feel the charger click into place. The AR Logo should face the front of the power bank when locked correctly. The battery level indicator lights will flash to indicate charging and the capacity of the built-in battery. To remove the battery from the base, turn counter clockwise following the unlock icon.

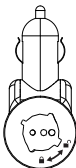

### Charging the Power Bank Using a Micro USB Power Cable

Connect the provided micro USB cable to the USB Micro input jack on the side of the power bank. Connect the other end of the cable to a USB power source (like the charger provided by your device, a computer or any USB charger). The battery level indicator lights will flash to indicate charging and the capacity of the built-in battery.

## Checking the Power Bank Battery Level

The battery level indicator on the front of the power bank indicates the capacity of the built-in battery.

Number of LED lit	Built-in battery capacity
0	0%
1	33%
2	67%
3	100%

**Note:** If no button is pressed in 20 seconds, the power bank will enter stand by mode.

## Charging your device with the Power Bank

Connect the USB cable provided with your device to the USB output jack on the side of the power bank to start charging.

We recommend to fully charge your power bank at least once every four months to extend lifespan.

Even though your Zipstick comes charged from the factory, for best results, we recommend you recharge your Zipstick fully before the first time you use it with your phone. You might notice that the capacity of the Zipstick's battery seems to increase after the first or second time you use and recharge it. This is normal: all Lithium-Ion rechargeable batteries take a few charges before they reach their peak capacity.

### Important note about device charging

If the device connected for charging is trying to draw more current than the charge is capable of, this charger has an over current protection (OCP) feature that will stop charging to protect your devices.

## Charging your device with the Car Charger

To charge via the USB output jack of the car charger, plug the charger into the cigarette socket. The Green LED will be turned on. Connect the USB cable provided with your device to the USB output jack of the car charger to start charging.

## Flashlight

To use the flashlight, press and hold the On/Off button on the front of the power bank for 3 seconds. To turn the flashlight off, press and hold the On/Off button for 3 seconds.

## Specifications

### Power Bank

Battery type: Li-ion rechargeable battery

Capacity: 2,200mAh

Micro USB Input: 5.0V / 1.0 A

USB Output: 5.0V / 1.0 A

### Car Charger

DC input: 10V ~ 16V

USB Output: 5V / 2.4A

## Limited 12 Month Warranty

Voxx Accessories Corp. warrants that for 12 months from date of purchase, it will replace this product if found to be defective in materials or workmanship. Return it to the address below for a replacement with a current equivalent. This replacement is the company's sole obligation under this warranty. ANY IMPLIED WARRANTY OF MERCHANTABILITY OR FITNESS FOR A PARTICULAR USE IS DISCLAIMED. This warranty excludes defects or damage due to misuse, abuse, or neglect. Incidental or consequential damages are disclaimed where permitted by law. This warranty does not cover product purchased, serviced or used outside the United States or Canada.

**U.S.A.:** Audiovox Return Center, 150 Marcus Blvd., Hauppauge, New York 11788

**CANADA:** Audiovox Return Center, c/o Genco, 6685 Kennedy Road, Unit #3 Door 14, Mississauga Ontario L5T 3A5