

Programming The Energy Power™ Bar One To Your TV Remote

The Energy Power™ Bar One soundbar has four control buttons under the status indicator light on its front panel. From the top button down, they are SOURCE, MUTE, VOLUME UP, and VOLUME DOWN. The Mute, Volume Up and Volume Down buttons can easily be programmed to your TV, Satellite or Cable box remote control so that you can use that remote to control these functions.

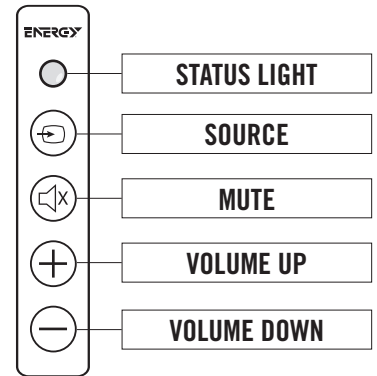

Easy, Three-Step Remote Programming

The following 3 steps should be used to program each function of your TV or cable box remote control buttons (MUTE, VOLUME UP, and VOLUME DOWN). **IF THE SOUNDBAR IS IN STANDBY MODE** (solid RED status light), push the <SOURCE> button on the soundbar until the status light is solid GREEN.

STEP ONE (Place the unit in learning mode): With the status light showing solid GREEN, press and hold the <SOURCE> and <MUTE> buttons on the front of the soundbar at the same time (approximately 3 seconds) until the status light flashes ORANGE.

STEP TWO (Select the function to learn): Press the <MUTE> button once on the soundbar (the status light changes to solid ORANGE). (Substitute the VOLUME UP & VOLUME DOWN in place of <MUTE> when programming the other buttons during this step)

STEP THREE (Learn the function): Hold your TV or cable box remote control within one foot and pointed at the front of the soundbar. Slowly press the <MUTE> button on your remote control four times. On the first three presses, the status indicator light will flicker ORANGE with each press. If the unit has successfully learned the function, on the fourth press of the button, the light will flash GREEN several times and then turn to solid GREEN. (Remember to use the VOLUME UP, and VOLUME DOWN in place of <MUTE> when programming the other buttons during this step)

To program the remaining functions, simply repeat all steps, substituting <MUTE> with the new function and button presses (VOLUME UP, and VOLUME DOWN) on steps TWO and THREE.

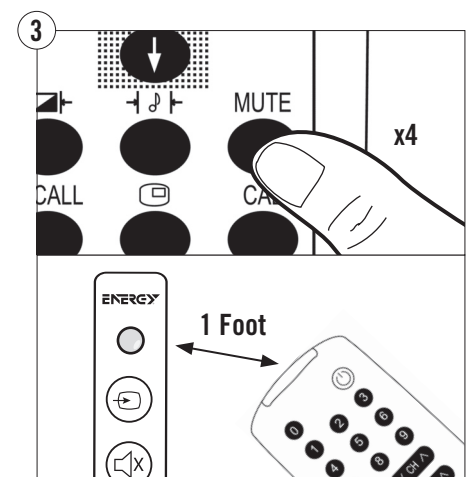
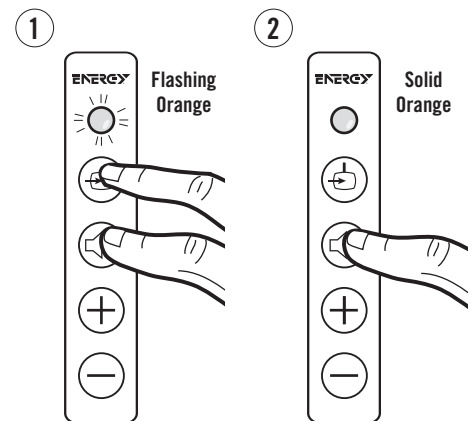

Connecting The Energy Power™ Bar One

Step 1

Once you have placed the Energy Power™ Bar One soundbar where you want it either below or above your TV, connect one end of the supplied 3.5mm to Dual RCA cable to your TV's 3.5mm/Headphone audio output jack and connect the other end of the cable into the L/R RCA input jacks on the rear of the soundbar.

NOTE: THE SOURCE BUTTON ON THE SOUNDBAR SWITCHES INPUTS BACK AND FORTH FROM OPTICAL TO L/R RCA.

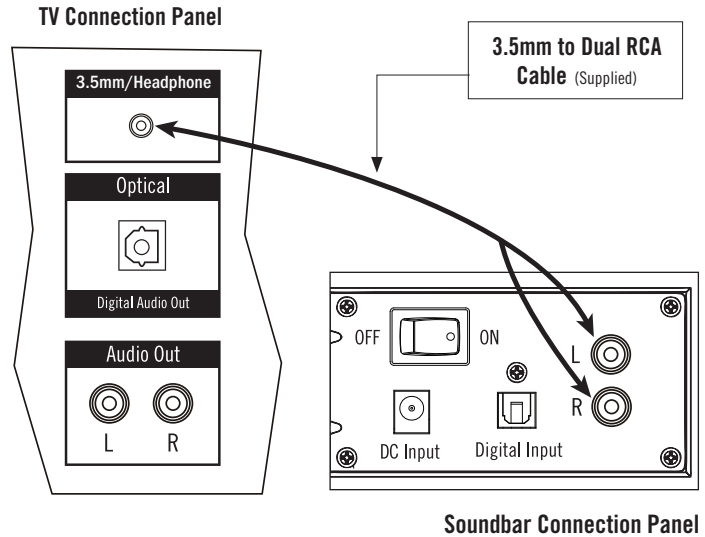

Step 2

Next, plug the AC power cord into the soundbar power supply, then connect the power supply into the DC Input on the rear of the soundbar. Plug the AC power supply into a "live" electrical outlet and turn the soundbar's Main Power switch on the rear of the soundbar to "On". On the front of the soundbar, make sure the status light is either solid green or orange (press any button once if light is steady red).

Your Energy Power™ Bar One soundbar is now ready to operate!

See Owner's Manual for additional hookup options.

