



## GETTING STARTED

## Welcome to RCA Symphonix!

This guide takes you through the steps to get started:

- + Installing the battery:** The RPSA05 earpiece uses a replaceable battery. We've included one in the package.
- + Using the earpiece:** Customize Symphonix to your preferences and adjust it to your environment.

## Installing the Battery

1

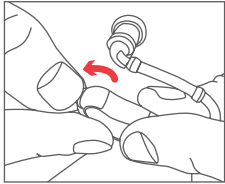

Open the battery door on the back of the earpiece.

2

Find the battery bag (inside the storage case). Remove the battery from the bag.

3

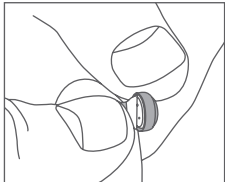

Peel the protective tab off the back of the battery.

4

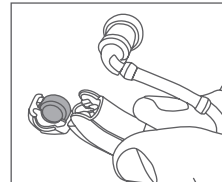

Place the battery into the battery door.

5

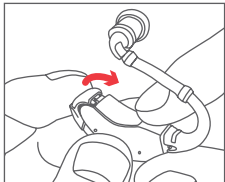

Close the battery door completely.

**IMPORTANT:** Once you close the battery door, the RPSA05 is on and ready to use. The earpiece stays on until the battery runs out of power or you open the battery door again. If you're not going to use the earpiece for a while, open the battery door to conserve battery power.

**NOTE:** Normal battery life for the RPSA05 earpiece is 7 full days of use. Replacement batteries are available at [RCASymphonix.com](http://RCASymphonix.com) or through the Accessories brochure in this package.

*Turn over for usage instructions.*

## Using the earpiece

1



Make sure your ears are clean!

Wax is the #1 reason hearing products fail. Keep your Symphonix earpiece away from wax as much as possible.

2

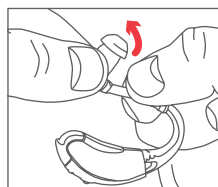

Twist the dome to the correct side for your ear.

3

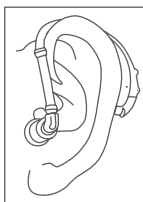

Put the earpiece body behind your ear.

4



Insert the dome in your ear gently and wiggle it into the ear canal.

5



Adjust the volume level (if necessary).

The earpiece starts at volume level 1 when you turn it on. Press the volume button (shown here) to select one of the three volume levels. The number of beeps you hear tells you which level you're on.

## Getting used to using RCA Symphonix

### *Wearing the earpiece*

The earpiece might be uncomfortable at first. Having something new in your ear might take a few days to get used to, but any discomfort should subside after a few days. If it doesn't, you might want to try the small dome included in this package (see the directions in the User Guide) or one of the other tubes and domes listed in the Accessories folder in this package or on [RCASymphonix.com](http://RCASymphonix.com).

### *Hearing new sounds*

RCA Symphonix lets you experience sounds you might not be used to hearing, everyday sounds like clocks ticking, paper rustling or crinkling, nearby whispering or soft conversation, outdoor noises like wildlife or traffic, or nearby footsteps. It might take you a while to get used to all these new sounds...at first, they might be distracting.

For care and cleaning, troubleshooting, and more detailed setup information, see the User Guide.