



user manual manual de usuario guide de l'utilisateur

RCD215

Product registration

Thank you for purchasing an RCA product. We pride ourselves on the quality and reliability of all our electronic products but if you ever need service or have a question, our customer service staff stands ready to help.

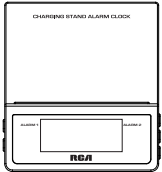

Enregistrer le produit de votre appareil. Merci d'avoir acheté un produit RCA. Nous sommes fiers de la qualité et de la fiabilité de tous nos produits électroniques, mais en cas de nécessité de réparation ou pour toute question, le personnel de notre service clientèle est prêt à vous aider.

Enregistrement du produit. Merci d'avoir acheté un produit RCA. Nous sommes fiers de la qualité et de la fiabilité de tous nos produits électroniques, mais en cas de nécessité de réparation ou pour toute question, le personnel de notre service clientèle est prêt à vous aider.

ENE/FF

It is important to read this user manual prior to using your product for the first time. Es importante leer este manual antes de usar por vez primera su equipo.

Docking your device

- 5. Dock your device vertically or horizontally.

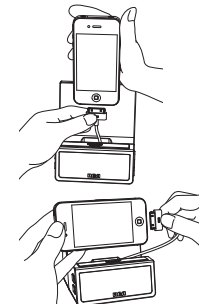

- 6. You can simply wrap the cable around the side of the dock if you prefer.

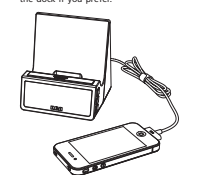

Warranty information

12 Month Limited Warranty Applies to RCA Clock Radios. VOXX Accessories Corporation (the Company) warrants to the original purchaser of this product that should this product or any part thereof under normal use and conditions, be proven defective in material or workmanship within 12 months from the date of original purchase, such defect(s) will be repaired or replaced with reconditioned product (at the Company's option) without charge for parts and cost of labor.

This Warranty does not extend to the elimination of externally generated static or noise, to correction of antenna problems, loss/interruptions of broadcast or internet service, to costs incurred for installation, removal or reinstallation of product, to corruptions caused by computer viruses, spyware or other malware, to loss of media, files, data or content, or to damage to tapes, disks, removable memory devices or cards, speakers, accessories, computers, computer peripherals, other media players, home networks or vehicle electrical systems.

This Warranty does not apply to any product or part thereof which, in the opinion of the Company, has suffered or been damaged through alteration, improper installation, mishandling, misuse, neglect, accident, or by removal or detachment of the factory serial number/code label(s). THE EXTENT OF THE COMPANY'S LIABILITY UNDER THIS WARRANTY IS LIMITED TO THE REPAIR OR REPLACEMENT PROVIDED ABOVE AND, IN NO EVENT, SHALL THE COMPANY'S LIABILITY EXCEED THE PURCHASE PRICE PAID BY PURCHASER FOR THE PRODUCT.

This Warranty is in lieu of all other express warranties or liabilities. ANY IMPLIED WARRANTIES, INCLUDING ANY IMPLIED WARRANTY OF MERCHANTABILITY, SHALL BE LIMITED TO THE DURATION OF THIS WRITTEN WARRANTY. ANY ACTION FOR BREACH OF ANY WARRANTY HEREUNDER INCLUDING ANY IMPLIED WARRANTY OF MERCHANTABILITY WHICH OTHER THAN EXPRESSED HEREIN IN CONNECTION WITH THE SALE OF THIS PRODUCT...

English

IMPORTANT SAFETY INSTRUCTIONS

PLEASE READ AND SAVE THIS FOR FUTURE REFERENCE

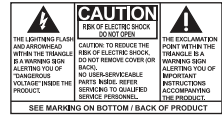

WARNING: TO PREVENT FIRE OR ELECTRICAL SHOCK HAZARD, DO NOT EXPOSE THIS PRODUCT TO RAIN OR MOISTURE.

- Some of the following information may not apply to your particular product; however, as with any electronic product, precautions should be observed during handling and use. Read these instructions. Keep these instructions. Read all warnings. Do not attempt to disassemble the cabinet. This product does not contain customer serviceable components. Do not attempt to disassemble the cabinet. This product does not contain customer serviceable components. Do not attempt to disassemble the cabinet. This product does not contain customer serviceable components.

the apparatus, the apparatus has been exposed to rain or moisture, does not operate normally, or has been dropped.

ADDITIONAL SAFETY INFORMATION

- The ACDC adaptor supplied with this product is intended to be correctly oriented in a vertical or floor mount position. Do not use unauthorised chargers or power adapters. Use only chargers or power adapters that came with your product or that are listed in the user manual. Apparatus shall not be exposed to dripping or splashing and no objects filled with liquids, such as glasses, should be placed on the apparatus. Always leave sufficient space around the product for ventilation. Do not place product in or on a bed, rug, bookcase or cabinet that may prevent air flow through vent openings. Do not place litged candles, cigarettes, cigars, etc. on the product. Care should be taken so that objects do not fall into the product. Do not attempt to disassemble the cabinet. This product does not contain customer serviceable components. Do not attempt to disassemble the cabinet. This product does not contain customer serviceable components.

Electrical consumption ACDC adaptor: Input: AC 120 - 240 V - 50/60 Hz Output: DC 5V - 2A

FCC Information

Note: This equipment has been tested and found to comply with the limits for a Class B digital device, pursuant to Part 15 of FCC Rules. These limits are designed to provide reasonable protection against harmful interference in a residential installation. This equipment generates, uses, and can radiate radio frequency energy and, if not installed and used in accordance with the instructions, may cause harmful interference to radio communications.

However, there is no guarantee that interference will not occur in a particular installation. If this equipment does cause harmful interference to radio or television reception, which can be determined by turning the

- equipment off or on, the user is encouraged to try to correct the interference by one or more of the following measures: Reorient or relocate the receiving antenna. Increase the separation between the equipment and receiver. Connect the equipment into an outlet on a circuit different from that to which the receiver is connected. Consult the dealer or an experienced radio/TV technician for help.

Changes or modifications not expressly approved by VOXX Accessories Corporation could void the user's authority to operate the equipment.

Industry Canada Regulatory Information CAN ICES-3 (B)/NMB-3 (B) Avis de l'industrie Canada CAN ICES-3 (B)/NMB-3 (B)

Before you begin

- Plugging in for power Connect the supplied power adapter to the unit's Power Jack, and connect the other end to a convenient wall outlet. Once connected with power, the clock flashes. Refer to the Clock section for instructions on properly setting the Clock.

General controls

Right view OFF - Turn the alarm off. AL 1 - Activate or deactivate Alarm 1. AL 2 - Activate or deactivate Alarm 2.

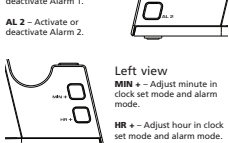

Left view MIN - Adjust minute in dock set mode and alarm mode. HR - Adjust hour in dock set mode and alarm mode.

MIN - Adjust minute in dock set mode and alarm mode. HR - Adjust hour in dock set mode and alarm mode.

General controls



SNOWE/BRIGHTNESS - Turn off the alarm function momentarily (10 minutes); adjust the display brightness.

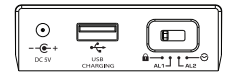

Back view DC 5V - Connect to the supplied power adapter.

USB CHARGING - Charge USB powered devices.

AL 1/AL 2 - Slide switch to set Lock, Alarm 1, Alarm 2, and clock time.

Setting Clock Time

- 1. Slide the switch AL 1/AL 2 to clock position. Press HR + and MIN + to set the time. Press and hold to decrease or increase the time value quickly. The clock is in 12 hour format. The AM/PM indicator appears to show AMPM time. Slide the switch AL 1/AL 2 to lock position when finished.

Setting Alarm Time

- This unit allows 2 alarm times to be set. 1. Slide the switch AL 1/AL 2 to AL 1 or AL 2 position. Press HR + and MIN + to set the alarm time. Press and hold to decrease or increase the time value quickly. The alarm time and the corresponding alarm indicator (ALARM 1 or ALARM 2) flash. Slide the switch AL 1/AL 2 to position to toggle the alarms on and off. You will see a solid when the alarm is active. Follow steps 1 through 4 to set ALARM 2.

Setting Alarm Time

- Ways to turn off alarm To silence the alarm function momentarily, press SNOOZE. The indicator will be flashing during the snooze period. The alarm will be on again when the snooze period (10 minutes) is over. To turn off the alarm, press OFF. The alarm will activate again the next day. To disable the alarm function completely, press AL 1 or AL 2 repeatedly until no indicator shows on the display.

USB charging

Use USB charging port at the back of the dock to charge your smartphone or to power USB powered devices such as a USB type lamp or fan.

To connect your cell phone for charging: Use a USB cable (not included) to connect your cell phone to the USB connector of the dock. Your cell phone should start charging.

Docking your device

- 1. Insert the USB cable (not included) through the hole in the included rubber tie. 2. Wrap the tie around the excess cabling and back onto itself to secure.

Docking your device

- 3. Push your USB cable (not included) through the hole of the soft dock.

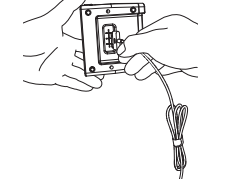

- 4. Leave a little slack in the cable to allow you to pull some of the cable out when connecting to your device.

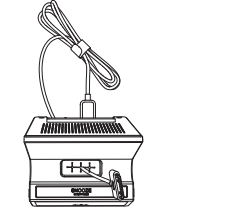

Español IMPORTANTE INSTRUCCIONES DE SEGURIDAD

FAVOR DE GUARDAR ESTO PARA UNA REFERENCIA FUTURA

calificado. El servicio es requerido cuando el aparato ha sido dañado de alguna forma, tal como daño a la clavija o al cable de corriente, cuando se ha derramado líquido o han caído objetos dentro del aparato, el aparato ha sido expuesto a lluvia o humedad, no funciona normalmente, o ha sido tirado.

INFORMACION ADICIONAL DE SEGURIDAD El adaptador CA/DC suministrado con este producto está diseñado para estar orientado correctamente en una posición de montaje vertical en el piso.

- No use cargadores o adaptadores de corriente no autorizados. Sólo utilice cargadores o adaptadores de corriente que vengan con su producto o que estén listados en el guía del usuario. El aparato no debe quedar expuesto a gotas o salpicaduras de líquidos, y por lo tanto, se deben colocar sobre el aparato objetos que contengan líquidos, como por ejemplo vasos. Siempre deje suficiente espacio para ventilación alrededor del producto. No ponga el producto en la cama, alfombra, librero o gabinete que pueda obstruir la corriente de aire a través de aperturas de ventilación. No pongan velas, cigarrillos o cigarros encendidos encima del producto. Tome precauciones para evitar que caigan objetos dentro del producto. No intente desmontar el gabinete. Este producto no contiene componentes que requieran servicio por parte del cliente.

- La información de señalamiento, está ubicada en la parte inferior del aparato. Para desconectar completamente la entrada de corriente, el adaptador CA/DC del aparato deberá desconectarse de la toma de corriente. El adaptador CA/DC es un dispositivo de desconexión. El adaptador de CA/DC no deberá ser bloqueado o deberá ser fácilmente accesible durante el uso para el cual está diseñado. No se deberá obstruir la ventilación cubriendo las aperturas de ventilación con elementos tales como periódicos, papeles, etcétera. Ninguna fuente de flama abierta, tal como velas encendidas, deberá colocarse sobre el aparato. Se deberá poner atención a los aspectos ambientales al eliminar las baterías. El uso del aparato en climas moderados.

Consumo eléctrico Adaptador CA/DC: Entrada: CA 120 - 240 V - 50/60 Hz Salida: DC 5V - 2A

Advertencia sobre el Carro Portátil

Controles generales

Vista derecha OFF - Apaga la alarma.

AL 1 - Activa o desactiva Alarm 1. AL 2 - Activa o desactiva Alarm 2.

Vista izquierda MIN - Ajusta el minuto en modo ajuste de reloj y modo alarma. HR - Ajusta la hora en modo ajuste de reloj y modo alarma.

Vista superior SNOOZE - Desactiva momentáneamente la función alarma (10 minutos); ajusta el brillo de pantalla.

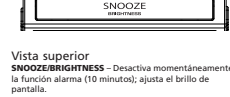

Vista posterior DC 5V - Conecta con el adaptador de corriente suministrado. USB CHARGING - Carga dispositivos alimentados por USB.



AL 1/AL 2 - Dedice el interruptor para establecer Bloqueo, Alarma 1, Alarma 2, hora del reloj.

Ajuste de la Hora del Reloj

- 1. Deslice el interruptor AL 1/AL 2 a la posición reloj. 2. Presione HR + y MIN + para ajustar la hora. 3. Presione y mantenga presionado para disminuir o aumentar rápidamente el valor del tiempo. La hora de alarma y el indicador de temporizador de alarma correspondiente ALARM 1 o ALARM 2 parpadeará. 4. Deslice el interruptor AL 1/AL 2 a la posición para bloquear la posición AL 1/AL 2 para terminar.

Ajuste del Tiempo de Alarma

- Esta unidad permite establecer 2 tiempos de alarma. 1. Deslice el interruptor AL 1/AL 2 a la posición AL 1 o AL 2. 2. Presione HR + y MIN + para establecer la hora de alarma. 3. Presione y mantenga presionado para disminuir o aumentar rápidamente el valor del tiempo. La hora de alarma y el indicador de temporizador de alarma correspondiente ALARM 1 o ALARM 2 parpadeará. 4. Deslice el interruptor AL 1/AL 2 a la posición para bloquear la posición AL 1/AL 2 para terminar.

Si sigue los pasos 1 a 4 para establecer ALARMA 2.

- Formas de apagar la alarma Para silenciar momentáneamente la función despertador, presione SNOOZE. El indicador estará parpadearando durante el periodo dormitar. La alarma se encenderá otra vez cuando el periodo dormitar (10 minutos) termine. Para apagar la alarma, presione OFF. La alarma se activará otra vez al día siguiente. Para desactivar completamente la función alarma, presione AL 1 o AL 2 repetidamente hasta que ningún indicador se muestre en la pantalla.

Carga USB

Para conectar su teléfono celular para carga: Use un cable USB (no incluido) para conectar su teléfono celular al conector USB del acoplador. Su teléfono celular debería comenzar la carga.

La función de carga puede no estar soportada para todos los teléfonos o dispositivos electrónicos.

